

# User's Manual

DARE TO LIV



## TABLE OF CONTENTS

<b>Caliber 10</b>	PAGE 3
<b>Caliber 11</b>	PAGE 4
<b>Caliber 12</b>	PAGE 6
<b>Caliber 14</b>	PAGE 9
<b>Caliber 15</b>	PAGE 12
<b>Caliber 16</b>	PAGE 14
<b>Caliber 17</b>	PAGE 19
<b>Caliber 18</b>	PAGE 21
<b>Caring for your LIV Swiss Watch</b>	PAGE 24
<b>FAQ</b>	PAGE 28

# Caliber 10 User's Manual

## THE MOVEMENT

### DESCRIPTION:

- Made in Switzerland
- Powered by a battery

### PERFORMANCE:

- Standard battery life of 45 months

### DISPLAY:

- Hours-minutes-seconds
- Date window

## PARTS OF YOUR NEW WATCH

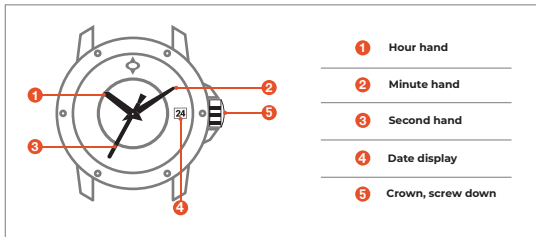

- 1 Hour hand**
- 2 Minute hand**
- 3 Second hand**
- 4 Date display**
- 5 Crown, screw down**

## SETTING YOUR WATCH

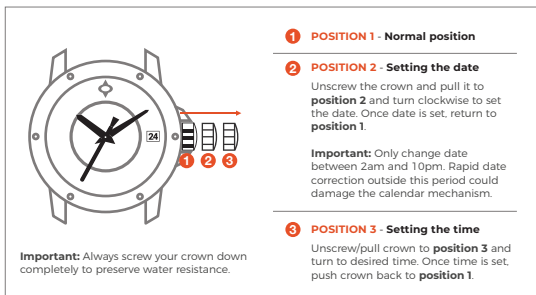

### 1 POSITION 1 - Normal position

### 2 POSITION 2 - Setting the date

Unscrew the crown and pull it to **position 2** and turn clockwise to set the date. Once date is set, return to **position 1**.

**Important:** Only change date between 2am and 10pm. Rapid date correction outside this period could damage the calendar mechanism.

### 3 POSITION 3 - Setting the time

Unscrew/pull crown to **position 3** and turn to desired time. Once time is set, push crown back to **position 1**.

**Important:** Always screw your crown down completely to preserve water resistance.

# Caliber 11 User's Manual

## THE MOVEMENT

### ► DESCRIPTION:

- Made in Switzerland
- Functions without a battery; powered automatically with the movement of your arms

### ► PERFORMANCE:

- Balance frequency of 28,800 vibrations per hour (4 Hz)
- Power reserve of 38 hours

### ► DISPLAY:

- Hours-minutes-seconds
- Date window

## PARTS OF YOUR NEW WATCH

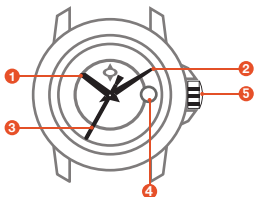

- 1 Hour hand
- 2 Minute hand
- 3 Second hand
- 4 Date display
- 5 Crown, screw down

# Caliber 11 User's Manual

CONTINUED

## SETTING YOUR WATCH



### 1 POSITION 1 - Normal position

### 2 POSITION 2 - Winding your watch

Unscrew crown and pull to position 2. With the crown in **position 2**, wind the watch about 30 times. This will power the mainspring of your watch. The rotor will continue to wind the watch as you wear it and keep the watch going. The watch has a power reserve of 38 hours.

### 3 POSITION 3 - Setting the date

Turn crown clockwise to set the date. **Warning:** Only change date between 2am and 10pm. Rapid date correction outside this period could damage the calendar mechanism.

### 4 POSITION 4 - Setting the time

Turn crown to desired time. **Important:** To preserve your watch's water-resistance, always **push or screw down** the crown to **position 1** when done.

\* When a mechanical self-winding watch is not worn for a certain amount of time, its power reserve (in this case, 38 hours) is exhausted and the watch stops. To restart it, unscrew the crown to position II and wind the movement manually by turning the crown 30- 40 times. This will give it a sufficient power reserve to function normally.

# Caliber 12 User's Manual

## THE MOVEMENT

### ► DESCRIPTION:

- Made in Switzerland
- Functions without a battery; powered automatically with the movement of your arms

### ► PERFORMANCE:

- Balance frequency of 28,800 vibrations per hour (4 Hz)
- Power reserve of 48 hours

### ► DISPLAY:

- Hours-minutes-seconds
- 60-second chronograph
- 30-minute counter
- 12-hour counter
- Date and day in window or date in window - varies by model

## PARTS OF YOUR NEW WATCH

### WATCH FUNCTIONS

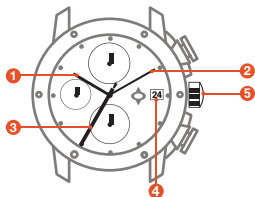

- 1 Hour hand
- 2 Minute hand
- 3 Chronograph Second hand
- 4 Date display
- 5 Crown, screw down

### CHRONOGRAPH FUNCTIONS

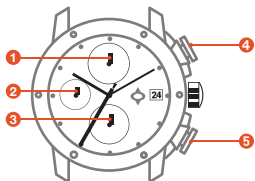

- 1 30-minute counter
- 2 Continuous running seconds
- 3 12-hour counter
- 4 Start / stop button
- 5 Zero reset button

# Caliber 12 User's Manual

CONTINUED

## SETTING YOUR WATCH

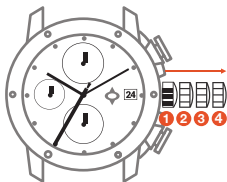

### 1 POSITION 1 - Normal position

### 2 POSITION 2 - Winding your watch

When a mechanical self-winding watch is not worn for a certain amount of time, its power reserve (in this case 48 hours) is exhausted. To restart, unscrew and pull the crown to **position 2** and wind manually by turning the crown 30-40 times.

### 3 POSITION 3 - Setting the date

Turn crown clockwise to set the date.  
**Warning:** Do not change date between 8pm and 2am. Rapid date correction during this period could damage the calendar mechanism.

### 4 POSITION 4 - Setting the time

Turn crown to desired time.  
**Important:** To preserve your watch's water-resistance, always **push or screw down** the crown to **position 1** when done.

## SINGLE TIMING

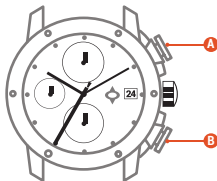

1 **Caution:** Before each timing, the hands must be at zero. If necessary, press button B.

2 **Start:** button A (START)

3 **Stop:** button A (STOP)  
 > Time read-out

4 **Reset to zero:** button B

# Caliber 12 User's Manual

CONTINUED

## CUMULATIVE TIMING

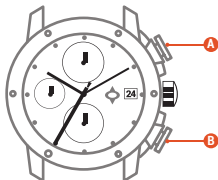

- 1 This function measures several consecutive times, adding them to give the total measured time.

---

- 2 **Caution:** Before each timing, the hands must be at zero. If necessary, press button B.

---

- 3 **Start 1st time:** button A (START)

---

- 4 **Stop 1st time:** button A (STOP)  
> Read 1st time

---

- 5 **Start 2nd time:** button A (START)

---

- 6 **Start 2nd time:** button A (STOP) Read 1st and 2nd times, etc

---

- 7 **Reset to zero:** button B

## CHRONOGRAPH DISPLAY

▶ START

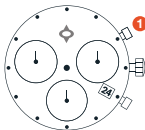

▶ STOP

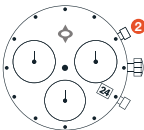

▶ RESET

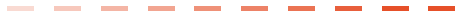
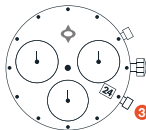



# Caliber 14 User's Manual

## THE MOVEMENT

### DESCRIPTION:

- Made in Switzerland
- Powered by a battery

### PERFORMANCE:

- Standard battery life of 50 months

### DISPLAY:

- 2 eyes
- Multifunction
- Alarm
- Big date
- Small seconds in subdial

## PARTS OF YOUR NEW WATCH

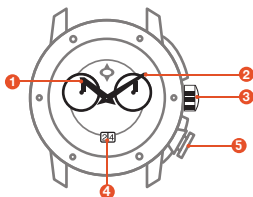

- 1 Hour hand
- 2 Minute hand
- 3 Crown, screw down
- 4 Date display
- 5 Alarm Button

# Caliber 14 User's Manual

CONTINUED

## SETTING YOUR WATCH

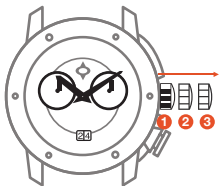

### 1 POSITION 1 - Normal position

### 2 POSITION 2 - Setting the date

Screw crown out and pull once to **position 2** and turn to set the date. **Important:** The date of the following day must be set in the calendar changing phase between 9pm and 12am.

### 3 POSITION 3 - Setting the time

Unscrew/pull crown to **position 3** and turn to desired time. **Important:** To set time to the exact second, pull crown to **position 3** when the second hand is at "60". Once the hour and minute hands have been set, push the crown back to **position 1** and screw down to preserve the water resistance.

## THE ALARM

**Setting Alarm** - 1. Activate alarm mode by holding **button A** for 2 seconds until the small minute hand in the Alarm Reference subdial jumps forward 1 minute. 2. Short presses advance alarm time by a minute. Long presses advance alarm time until the button is released. **IMPORTANT:** After setting alarm, it takes 5 seconds for alarm to beep twice to notify you that it has been set.

**Turning Alarm ON/OFF** - Briefly press **button A** to turn alarm on/off.

**2 beeps:** Alarm is on **1 beep:** Alarm is off

# Caliber 14 User's Manual

CONTINUED

## SETTING THE REFERENCE TIME

**1** Unscrew/pull out the crown to position III (**Second hand stops. The display changes from alarm time to reference time.**)

**2** **Activating the setting mode**  
Press the push-button for at least 2 seconds. As soon as the **small minute hand** jumps forwards one minute this mode is active.

**3** **Short press** (less than 1 second):  
The reference time moves forward by the minute.  
**Medium press** (1-2 seconds):  
The reference time moves forward by the hour.  
**Long press** (Longer than 2 seconds):  
The reference time moves forward until the push-button is released.

**4** **Push the crown back into position I and screw down**  
The display changes from reference time to alarm time.  
A 1-beep signal indicates that the alarm is switched off.

**Please note:**  
The reference time must display the same time as the current time. This means that resetting the current time also requires correction of the reference time. Afterwards, the alarm time has to be reset.

### What is the reference time?

The current time is displayed by means of the hour and minute hand.

Parallel to the current time, the reference time runs in the background; the alarm time refers itself to this reference time. Thus, resetting the time also requires correction of the reference time.

If the reference time is not synchronized with the current time, the alarm signal will sound at a different time than the set alarm time.

# Caliber 15 User's Manual

## THE MOVEMENT

### ► DESCRIPTION:

- Made in Switzerland
- Powered by a battery

### ► PERFORMANCE:

- Standard battery life of 45 months

### ► DISPLAY:

- Hours-minutes-seconds
- Date window
- 24 hour hand – GMT function

## PARTS OF YOUR NEW WATCH

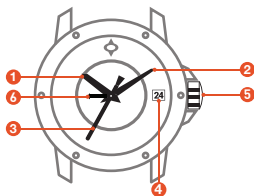

- 1 Hour hand
- 2 Minute hand
- 3 Second counter
- 4 Date display
- 5 Crown
- 6 GMT Hand

# Caliber 15 User's Manual

CONTINUED

## SETTING YOUR WATCH

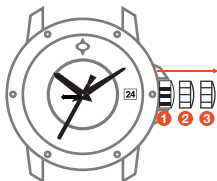

### 1 POSITION 1 - Normal position

### 2 POSITION 2 - Setting the date

Unscrew/pull crown to **position 2** and turn clockwise to set the date. Once date is set, return to **position 1**.

**Important:** The date can be corrected during the day-changing phase between 10pm and 12am. The date of the next day must be set because no automatic date change takes place at midnight.

#### Quick-change correction for 24-hour display

- Unscrew/pull the crown to **position 2** then turn counterclockwise until the desired time appears.
- Push the crown back into **position 1**.

### 3 POSITION 3 - Setting the time

Turn crown forward or backward to desired correction. Return to **position 1** when done.

# Caliber 16 User's Manual

## THE MOVEMENT

### DESCRIPTION:

- Made in Switzerland
- Powered by a battery

### PERFORMANCE:

- Standard battery life of 50 months

### DISPLAY:

- 3 eyes
- Chronograph
- Center stop second (1/1 sec)
- 30 minute counter
- ADD and SPLIT functions
- Day indicator
- Date
- Small second in subdial

## PARTS OF YOUR NEW WATCH

### WATCH FUNCTIONS

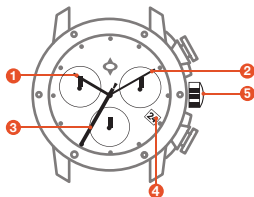

- 1 Hour hand
- 2 Minute hand
- 3 Chronograph seconds hand
- 4 Date display
- 5 Crown

### CHRONOGRAPH FUNCTIONS

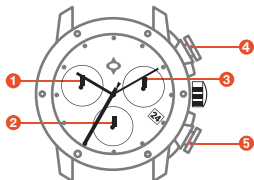

- 1 Day indicator
- 2 Continuous running Seconds
- 3 30 minute counter
- 4 Start / stop button
- 5 Zero reset button

# Caliber 16 User's Manual

CONTINUED

## SETTING YOUR WATCH

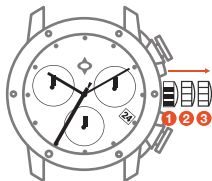

### 1 POSITION 1 - Normal position

### 2 POSITION 2 - Setting the date

Unscrew/pull crown to **position 2** and turn counterclockwise to set the date.

**Important:** During the date changing phase if the time is between **09:45 pm** and **12:00 pm**, the date must be set to the date of the next day.

### 3 POSITION 3 - Setting the time

Unscrew/pull crown to **position 3** and turn to desired time. **Important:** To set time to the exact second, unscrew/pull crown to **position 3** when the second hand is at **"60"**. Once the hour and minute hands have been set, push the crown back to **position 1**.

# Caliber 16 User's Manual

CONTINUED

## SETTING THE DATE, DAY OF OF THE WEEK, & TIME

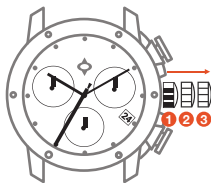

### Example:

- Date / time on the watch: 17 / 01:25 / MON
- Present date / time: 23 / 20:35 / THU
- \* Please observe the AM/PM clock rhythm

- 1 Unscrew/pull out the crown to position III (the watch stops).
- 2 Turn the crown clockwise until yesterday's day of the week WED appears.
- 3 Push the crown to position II.
- 4 Turn anti-clockwise to get to yesterday's date.
- 5 Unscrew/pull out the crown to position III (the watch stops).
- 6 Turn the crown anticlockwise until the correct date 23 and day of the week THU appears.
- 7 Continue to turn the crown anti-clockwise until the correct time 8:35 PM appears.
- 8 Push the crown back into position I.

## SINGLE TIMING

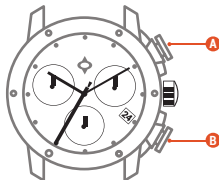

- 1 **Start:** Press push-button A
- 2 **Stop:** To stop the timing, press push-button A once more and read the chronograph counters; for example, 20 min/38 sec.
- 3 **Zero positioning:** Press push-button B. The chronograph hands will be reset to their zero positions.



# Caliber 16 User's Manual

CONTINUED

## ACCUMULATED TIMING

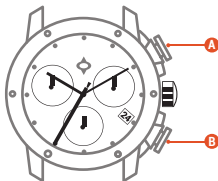

- 1 **Start:** Push button A (start timing)

---

- 2 **Stop:** Push button A again to see the time; e.g. 15 min 5 sec following.

---

- 3 **Restart:** Push button A again and timing is resumed.

---

- 4 **Stop:** Push button B to stop timing. The accumulated measured time is shown.

---

- 5 **Reset to zero:** Press and hold button B. The chronograph hands are returned to their zero positions. Please note: Following step 4, the accumulation of the timing can be continued by pressing button A (Restart / Stop, Restart / Stop, ...)

## INTERMEDIATE OR INTERVAL TIMING

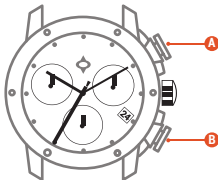

- 1 **Start:** Press button A, start timing.

---

- 2 **Display interval:** Press button A, and the interval time is displayed; e.g. 20 minutes 17 seconds. Timing continues in the background.

---

- 3 **Making up the measured time:** Press button A, and the chronograph hands are quickly advanced to the ongoing measured time.

---

- 4 **Stop:** Press button B, and the final time is displayed.

---

- 5 **Reset:** Press button B again. The chronograph hands are returned to their zero position. **Please note:** Following step 3, further intervals or intermediates can be displayed by pressing button B (display interval / makeup measured time, ...)

# Caliber 16 User's Manual

CONTINUED

## ADJUSTING THE CHRONOGRAPH HANDS



- 1** Pull the crown twice to position III

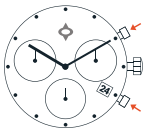

- 2** Hold both top and bottom buttons until the second hand of the chronograph does a complete turn indicating you are in set up mode.

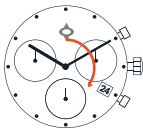

- 3** Use the top button to adjust any of the chronograph hands. Use the bottom button to switch between the different hands

- 4** To leave set up mode, push the crown back to position I.\*

\*Failure to push the crown all the way back in may result in water damage.

# Caliber 17 User's Manual

## THE MOVEMENT

### ► DESCRIPTION:

- Made in Switzerland

### ► PERFORMANCE:

- Self winding
- Frequency - 28,800 vibrations per hour

### ► DISPLAY:

- Hours-minutes-seconds
- Instantaneous date and moonphase indicators in window with quick corrector

## PARTS OF YOUR NEW WATCH

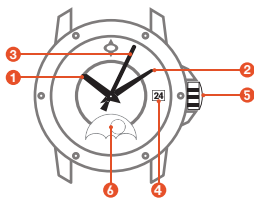

- 1 Hour hand
- 2 Minute hand
- 3 Second hand
- 4 Date display
- 5 Crown
- 6 Moonphase

# Caliber 17 User's Manual

CONTINUED

## SETTING YOUR WATCH

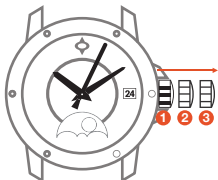

### 1 POSITION 1 - Normal position

---

### 2 POSITION 2 - Setting the date & moonphase

Unscrew/pull crown to **position 2** and turn clockwise to set the date. Once date is set, return to **position 1**.

**Important:** The date can be corrected during the day-changing phase between 10pm and 12am. The date of the next day must be set because no automatic date change takes place at midnight.

In **position 2**, turn the stem until the full moon appears in the middle of the opening. Determine the date of the last full moon with a calendar showing the moon phases. Then make one jump of moon phase indicator for each elapsed day since the last full moon.

---

### 3 POSITION 3 - Setting the time

Unscrew/pull crown to **position 3** and turn to desired time. Once time is set, push crown back to **position 1**.

# Caliber 18 User's Manual

## THE MOVEMENT

### DESCRIPTION:

- Made in Switzerland
- Powered by a battery

### PERFORMANCE:

- Standard battery life of 54 months

### DISPLAY:

- 1/10 second
- 3 eyes
- Chronograph
- Center stop second (1/1 sec)
- 1/10 seconds up to 30 minutes
- 30 minute counter
- 10 hour counter
- ADD and SPLIT functions
- Date window
- Small seconds in subdial

## PARTS OF YOUR NEW WATCH

### WATCH FUNCTIONS

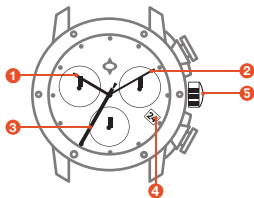

- Hour hand**
- Minute hand**
- Chronograph seconds hand**
- Date display**
- Crown, screw down**

### CHRONOGRAPH FUNCTIONS

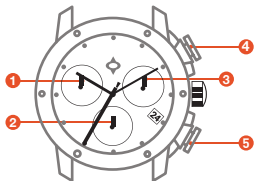

- 30 minute counter**
- 10 hour counter, 1/10 of a second**
- Constant running seconds**
- Start / stop button**
- Zero reset button**

# Caliber 18 User's Manual

CONTINUED

## SETTING YOUR WATCH

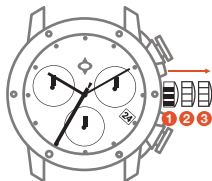

### 1 POSITION 1 - Normal position

### 2 POSITION 2 - Setting the date

Unscrew the crown and pull to position 2. Turn crown clockwise to set the date.

**Warning:** Only change date between 2am and 10pm. Rapid date correction outside this period could damage the calendar mechanism.

### 3 POSITION 3 - Setting the time

Turn crown to desired time.

**Important:** To preserve your watch's water-resistance, always push or screw down the crown to **position 1** when done.

## CHRONOGRAPH DISPLAY

▶ START

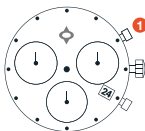

▶ STOP

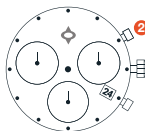

▶ RESET

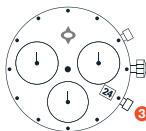

# Caliber 18 User's Manual

CONTINUED

## ADJUSTING THE CHRONOGRAPH HANDS



- 1** Unscrew crown and pull it twice to position III

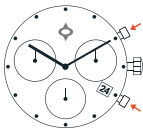

- 2** Hold both top and bottom buttons until the second hand of the chronograph does a complete turn indicating you are in set up mode.

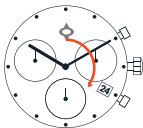

- 3** Use the top button to adjust any of the chronograph hands. Use the bottom button to switch between the different hands.

- 4** To leave set up mode, push the crown back to position I and tightly screw it back in.\*

\*Failure to tightly screw it back in may result in water damage

# Caring for your LIV Swiss Watch

## ► Cleaning

Clean your watch regularly as follows:

- 1.** Ensure that the crown is completely screwed down/pushed in before you get started.
- 2.** If the seals in your watch have been tested and changed within the last 12 months by an authorized LIV service center, then you may use a soft brush with mildly soapy water to clean case, then rinse it off with clear water and dry it with a soft cloth. If your watch is fitted with a fabric, alligator, leather or python skin strap, take care not to get it wet.
- 3.** If you have any doubts whatsoever about the water resistance of your watch, simply clean it with a soft brush, and then dry it. Avoid contact with detergents, solvents, cosmetics or any other chemical product, as these may damage the water-resistant gaskets and the bracelet.

## ► Condensation & Water Resistance

Some condensation may form under the crystal of your watch due to a sudden temperature change. This will disappear by itself and does not impact the watch's function. If the condensation persists, contact LIV or an authorized LIV dealer.

Given the nature of rubber seals, water resistance cannot be a permanent condition. The rubber seals are designed to prevent water entry, however the fact that they are under constant pressure means that over time they will deteriorate. It is therefore necessary, throughout your watch's warranty coverage period, to have the water-resistance tested by LIV or an authorized LIV repair center every two years after the date of purchase.

These tests are conducted free of charge. The International Warranty does not cover problems with water resistance and associated consequences if periodic water-resistance tests have not been conducted every two years following the date of purchase.



## Caring for your LIV Swiss Watch

---

### ► Crystals

The crystal in your watch may be coated with an anti-reflective treatment (single or double), to make the time more readable. Marks may appear due to normal wear and tear of the watch, and are not covered by the International Warranty. The coating will be sufficient with normal watch wear.

### ► Straps in Leather, Fabric, and Python/Alligator Skin

Be sure to avoid letting these watch straps get into contact with water. Please note that no matter how careful you are with leather, it is a living material and its color will naturally (slightly) fade or darken over time. Leather straps should be cleaned with a dry, soft cotton cloth. Avoid any abrasive products during cleaning.

### ► Silicone Straps

Since silicone attracts dust, there is an anti dust coating on the band which makes the silicone strap matte. It is normal for that coating to start coming off after approximately 6 months of everyday wear. The strap will begin to appear shiny as time progresses.

## Deployant Clasp

---

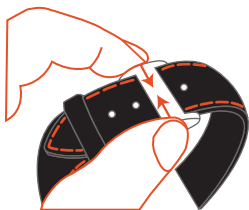

1. To open the clasp, press in the push-pieces on either side simultaneously.

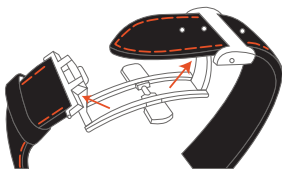

2. Open the clasp to enlarge the bracelet and remove the watch from your wrist.

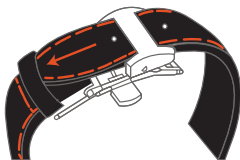

3. Put the strap on your wrist and slide the long section through the small fixed buckle.



4. Close the deployant clasp until it clicks into place. If necessary, slide the long section through the small mobile buckle.

## Adjusting the Clasp

---

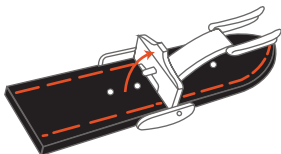

1. Release the adjusting mechanism by removing the pin from the hole in the long section of the strap.

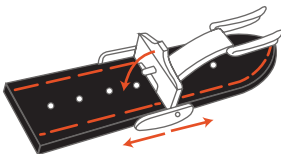

2. Slide the mechanism along the long section, then fix it by reinserting the pin in the desired hole.

▶ **Does the 1/10 of a second dial of the chrono stop after 30 seconds?**

It only stops SPINNING after 30 secs, but it is still calculating; the indication will show once you stop/pause the stop watch.

▶ **I've been setting the date at all times of the day and night but it always changes date at noon instead of midnight. What should I do?**

Your watch set to PM instead of AM – it's a 12 hour clock. So for example, your 11 AM is set to 11 PM. The date changes between 11 PM and 1 AM. You simply need to bring the time forward by 12 hours.

▶ **How do I get the full effect of the luminescence on my watch?**

In order to get the full effect of the luminescence, the watch needs to be in direct sunlight for at least 3 hours.

▶ **What does fully wound mean (on my automatic watch)?**

LIV automatic watches have a 38 to 48-hour power reserve, meaning that when fully wound and not worn, a LIV automatic watch will run for approximately 38 to 48 hours before stopping.

It's important to understand what fully wound means, as some people wrongly assume that just by wearing an automatic mechanical watch it will fully wind up by itself. That is not the case. The truth is that an automatic watch needs first to be fully wound and charged up by turning the crown. Then, by wearing the watch, the automatic movement will continue to hold the charge.

▶ **Does my level of activity make a difference to how long my LIV automatic watch will remain charged?**

YES!

Since the automatic watch gets its charging power from a rotating mass (aka the oscillating weight/rotor) inside the watch that relies on the movement of the wrist, your level of activity will determine how long the charge will hold.

Less active people might find that their watch has stopped because there is not enough movement to swing the rotating mass

▶ **Can a LIV automatic watch be 'over-wound'?**

YES! Each watch has its maximum charge, meaning that the mainspring (power source) can only hold so much charge.

Overwinding a watch could damage it, so it is always recommended to follow the instructions for your particular movement in this guide on how much you should wind the watch up the first time you put it on.

For your LIV automatic watch, we recommend you wind the watch 20 times the first time.

▶ **Does my LIV automatic watch need to be wound if I don't don't wear it, even if it's for a short period of time?**

Yes!

When you don't wear the watch (sleeping, shower) the watch is not active, and power will decrease during that period, so over a period of time, you might need to use the crown to bring the power back up.



DARE TO **LIV**

---

[WWW.LIVWATCHES.COM](http://WWW.LIVWATCHES.COM)